



**LOOKING FOR THAT SPECIAL PLACE TO
HOLD A GREAT PUBLIC OR PRIVATE EVENT?**

OUR LEGENDARY VENUE CAN PROVIDE THE PERFECT
BACKDROP FOR AN EPIC SHOW!



Oceana Theater was opened in 1934. Known later on as the Atlantic Oceana, the Millennium Theater and the Master Theater, in 2022 the theater returned to its historical name.

Now is a modern, excellently equipped **1326-seat** venue located in the heart of South Brooklyn's immensely popular Brighton Beach Area, by the beautiful ocean beaches, near convenient transportation means (subway, bus and easy driving access).





Oceana Theater is an ideal venue for concerts, theatrical performances, comedy shows, as well as graduation ceremonies, corporate events, conferences and so on.

Oceana Theater is a household brand name among the fun-loving and diverse crowd of Brooklyn residents. World-famous artists of a great variety, beloved ballet and drama troupes, as well as an endless list of dazzling pop performers from various countries of the world, have honored the stage with their talent and fame.



The theater is outfitted with cutting-edge sound and lighting equipment. It includes an extremely powerful, high-quality surround sound system carefully adjusted to the dimensions of the theater, capable of infinite adjustments to all various kinds of artist line-ups.

A multi-dimension, computerized stage lighting system provides dazzling light support to any kind of performance, from classical ballet to pop and rock concerts. The theater is equipped with an LED screen that adds to the beauty and excitement of any performance. The theater's professional team of sound, lighting and video engineers competently use wonders of modern technology to greatly enhance the excitement of any performance.



SEATING CHART

STAGE

Main Floor

A	28 24 22 20 18 16 14 12 10 8 6 4 2	108 107 106 105	104 103 102 101	1 3 5 7 9 11 13 15 17 19 21 23 25	A
B	28 26 24 22 20 18 16 14 12 10 8 6 4 2	110 109 108 107 106	105 104 103 102 101	1 3 5 7 9 11 13 15 17 19 21 23 25 27	B
C	30 28 26 24 22 20 18 16 14 12 10 8 6 4 2	110 109 108 107 106	105 104 103 102 101	1 3 5 7 9 11 13 15 17 19 21 23 25 27 29	C
D	32 30 28 26 24 22 20 18 16 14 12 10 8 6 4 2	112 111 110 109 108 107	106 105 104 103 102 101	1 3 5 7 9 11 13 15 17 19 21 23 25 27 29 31	D
E	32 30 28 26 24 22 20 18 16 14 12 10 8 6 4 2	112 111 110 109 108 107	106 105 104 103 102 101	1 3 5 7 9 11 13 15 17 19 21 23 25 27 29 31	E
F	30 28 26 24 22 20 18 16 14 12 10 8 6 4 2	114 113 112 111 110 109 108	107 106 105 104 103 102 101	1 3 5 7 9 11 13 15 17 19 21 23 25 27 29	F
G	30 28 26 24 22 20 18 16 14 12 10 8 6 4 2	114 113 112 111 110 109 108	107 106 105 104 103 102 101	1 3 5 7 9 11 13 15 17 19 21 23 25 27	G
H	28 26 24 22 20 18 16 14 12 10 8 6 4 2	116 115 114 113 112 111 110 109	108 107 106 105 104 103 102 101	1 3 5 7 9 11 13 15 17 19 21 23 25 27	H
J	26 24 22 20 18 16 14 12 10 8 6 4 2	118 117 116 115 114 113 112 111 110 109	108 107 106 105 104 103 102 101	1 3 5 7 9 11 13 15 17 19 21 23 25	J
K	24 22 20 18 16 14 12 10 8 6 4 2	118 117 116 115 114 113 112 111 110 109	108 107 106 105 104 103 102 101	1 3 5 7 9 11 13 15 17 19 21 23 25	K
L	24 22 20 18 16 14 12 10 8 6 4 2	118 117 116 115 114 113 112 111 110 109	108 107 106 105 104 103 102 101	1 3 5 7 9 11 13 15 17 19 21 23 25	L
M	22 20 18 16 14 12 10 8 6 4 2	120 119 118 117 116 115 114 113 112 111	110 109 108 107 106 105 104 103 102 101	1 3 5 7 9 11 13 15 17 19 21 23 25	M
N	20 18 16 14 12 10 8 6 4 2	120 119 118 117 116 115 114 113 112 111	110 109 108 107 106 105 104 103 102 101	1 3 5 7 9 11 13 15 17 19 21 23 25	N
P	18 16 14 12 10 8 6 4 2	122 121 120 119 118 117 116 115 114 113 112	111 110 109 108 107 106 105 104 103 102 101	1 3 5 7 9 11 13 15 17 19 21 23 25	P
Q	18 16 14 12 10 8 6 4 2	122 121 120 119 118 117 116 115 114 113 112	111 110 109 108 107 106 105 104 103 102 101	1 3 5 7 9 11 13 15 17 19 21 23 25	Q
R	16 14 12 10 8 6 4 2	124 123 122 121 120 119 118 117 116 115 114 113	112 111 110 109 108 107 106 105 104 103 102 101	1 3 5 7 9 11 13 15 17 19 21 23 25	R
S	14 12 10 8 6 4 2	118 117 116 115 114 113 112 111 110 109	108 107 106 105 104 103 102 101	1 3 5 7 9 11 13 15 17 19 21 23 25	S
T	14 12 10 8 6 4 2	124 123 122 121 120 119 118 117	108 107 106 105 104 103 102 101	1 3 5 7 9 11 13 15 17 19 21 23 25	T
V	12 10 8 6 4 2			1 3 5 7 9 11 13 15 17 19 21 23 25	V

FOH Area

Loge

W	127 126 125 124	123 122 121 120 119	109 108 107 106 105	104 103 102 101	W
AA	6 4 2	121 120 119	118 117 116 115 114 113 112 111 110 109 108 107 106 105 104	103 102 101	1 3 5 AA
BB	8 6 4 2	121 120 119	118 117 116 115 114 113 112 111 110 109 108 107 106 105 104	103 102 101	1 3 5 7 BB
CC	121 120 119	118 117 116 115 114 113 112 111 110 109 108 107 106 105 104	103 102 101		CC
DD	8 6 4 2	121 120 119	118 117 116 115 114 113 112 111 110 109 108 107 106 105 104	103 102 101	1 3 5 7 DD
EE	8 6 4 2	127 126 125 124 123 122 121 120 119 118 117 116 115 114 113 112 111 110 109 108 107 106 105 104 103 102 101			1 3 5 7 EE

Mezzanine

FF	26 24 22 20 18 16 14 12 10 8 6 4 2	115 114 113 112 111 110 109 108 107 106 105 104 103 102 101	1 3 5 7 9 11 13 15 17 19 21 23 25	FF
GG	26 24 22 20 18 16 14 12 10 8 6 4 2	115 114 113 112 111 110 109 108 107 106 105 104 103 102 101	1 3 5 7 9 11 13 15 17 19 21 23 25	GG
HH	147 146 145 144 143 142 141 140 139 138 137 136 135 134 133 132 131 130 129 128 127 126 125 124 123 122 121 120 119 118 117 116 115 114 113 112 111 110 109 108 107 106 105 104 103 102 101			HH
JJ	26 24 22 20 18 16 14 12 10 8 6 4 2	115 114 113 112 111 110 109 108 107 106 105 104 103 102 101	1 3 5 7 9 11 13 15 17 19 21 23 25	JJ
KK	26 24 22 20 18 16 14 12 10 8 6 4 2	115 114 113 112 111 110 109 108 107 106 105 104 103 102 101	1 3 5 7 9 11 13 15 17 19 21 23 25	KK
LL	147 146 145 144 143 142 141 140 139 138 137 136 135 134 133 132 131 130 129 128 127 126 125 124 123 122 121 120 119 118 117 116 115 114 113 112 111 110 109 108 107 106 105 104 103 102 101			LL
MM	18 16 14 12 10 8 6 4 2	124 123 122 121 120 119 118 117 116 115 114 113 112 111 110 109 108 107 106 105 104 103 102 101 100	9 11 13 15 17 19	MM
NN	18 16 14 12 10 8 6 4 2	124 123 122 121 120 119 118 117 116 115 114 113 112 111 110 109 108 107 106 105 104 103 102 101 100	1 3 5 7 9 11 13 15 17 19	NN
PP	10 8 6 4 2	124 123 122 121 120 119 118 117 116 115 114 113 112 111 110 109 108 107 106 105 104 103 102 101 100	1 3 5 7 9 11 13 15 17 19	PP
QQ	127 126 125 124 123 122 121 120 119 118 117 116 115 114 113 112 111 110 109 108 107 106 105 104 103 102 101 100		1 3 5 7 9 11 13 15 17 19	QQ
RR			1 3 5 7 9 11 13 15 17 19	RR

OCEANA THEATER TECHNICAL SPECIFICATIONS

House Sound System

Main Console

Midas M32 LIVE 40-channel Digital Mixer

Sends | Returns

Behringer S32 digital stage box

32 (thirty-two) sends from stage to mixer (2x16 stage boxes)

Patch Panel: 10 returns from mixer to stage (2 mains, 2 side fills, 6 monitor lines)

Main Speakers Line Arrays

(8) L- ACOUSTICS V-DOSC LF: 6000 W, MF: 4800 W, HF: 1600 W RMS
flown (4) cabinets per side

(8) L- ACOUSTICS SB28 (subwoofers): 9800 W RMS
flown (4) cabinets per side

(4) L-ACOUSTICS dV-DOSC (front fill): LF: 1520 W, HF: 264 W RMS
flown (2) cabinets per side

OCEANA THEATER TECHNICAL SPECIFICATIONS

House Sound System

Monitor Speakers

(4) L-ACOUSTICS ARCS LF (side fill): 1800 W, HF: 400 W RMS

(2) cabinets per side

(4) L-ACOUSTICS 115FM LF (stage monitors): 375 W, HF: 75 W RMS

(4) EAW SM155e (stage monitors): 480 W RMS

Stands & Risers	Quantity
Microphone Straight Stand	3
Microphone Boom Stand	11
Guitar Stand	4
Note Stand	4
1-tier Keyboard Stand	1
2-tier Keyboard Stand	1
4' x 4' Stage Riser	6

Additional
Equipment
Available for
Rental

Guitar Combo (available for extra \$50)

Marshall MG250DFX - 1

Bass Amp/Cabinets (available for extra \$150)

Hartke HA4000 - 1

Hartke XL115 - 1

Hartke XL410 - 1

Drum Set: Pearl All Maple Shell (available for extra \$300)

Bass Drum: 22"

Snare Drum: Mirror Chrome Steel Shell 14x5"

Toms: 10", 12", 13" | Floor Tom: 16"

Stands: one (1) HH Stand, four (4) Cymbal Stands

Cymbals: Zildjian New Beat Hi Hat 14", Sabian B8 Thin Crash 16",

Paiste 802 Ride 20", Zildjian A Medium crash 18", Sabian B8 Crash Ride 18"

Pedal: one (1)

Additional
Equipment
Available for
Rental

Microphones: eight (8) channels available

Shure ULXD4 Wireless Receiver G50 (8)
Shure ULXD2/B58 Wireless transmier G50 (8)
Shure UA844SWB Antenna Distribution System (2)
Shure UA221 Antenna Splier/Combiner (2)
Shure UA850 50' Coaxial Cable (2)
Shure UA874US Active Directional Antenna (2)

**\$100 per
channel**

In-Ear system: four (4) channels available

PSM 900 Personal Monitor System G6
P9RA Rechargeable Bodypack Receiver for Shure (4)
P9T PSM®900 Wireless Single-Channel (4)
Rackmount Transmier G6 (4)
PA805SWB Passive Directional Antenna 470-952 MHz (1)
Includes 10' BNC/BNC Cable (1)
PA421A Four Port PSM Antenna Combiner 470-952 MHz (1)

**\$100 per
channel**

Additional
Available
Inventory

Korg Krome 61 music workstation

\$150

K&M Spider Pro Keyboard Stand (silver)

\$20

Epiphone Acoustic Electric EJ-200SCE/VN

\$70

Yamaha Acoustic Electric FX370C BL

\$70

(2) K&M 26200 Elegance Mic Stand

\$15 each

Radial Pro D2 (passive stereo direct box)

\$25

Radial Pro AV2 (multi-media direct box)

\$25

Radial Pro DI (passive direct box)

\$15

(2) Elation Magma Prime 700W Haze Machine (fluid included)

\$30 each

OCEANIA
THEATER



LIGHTING PLOT

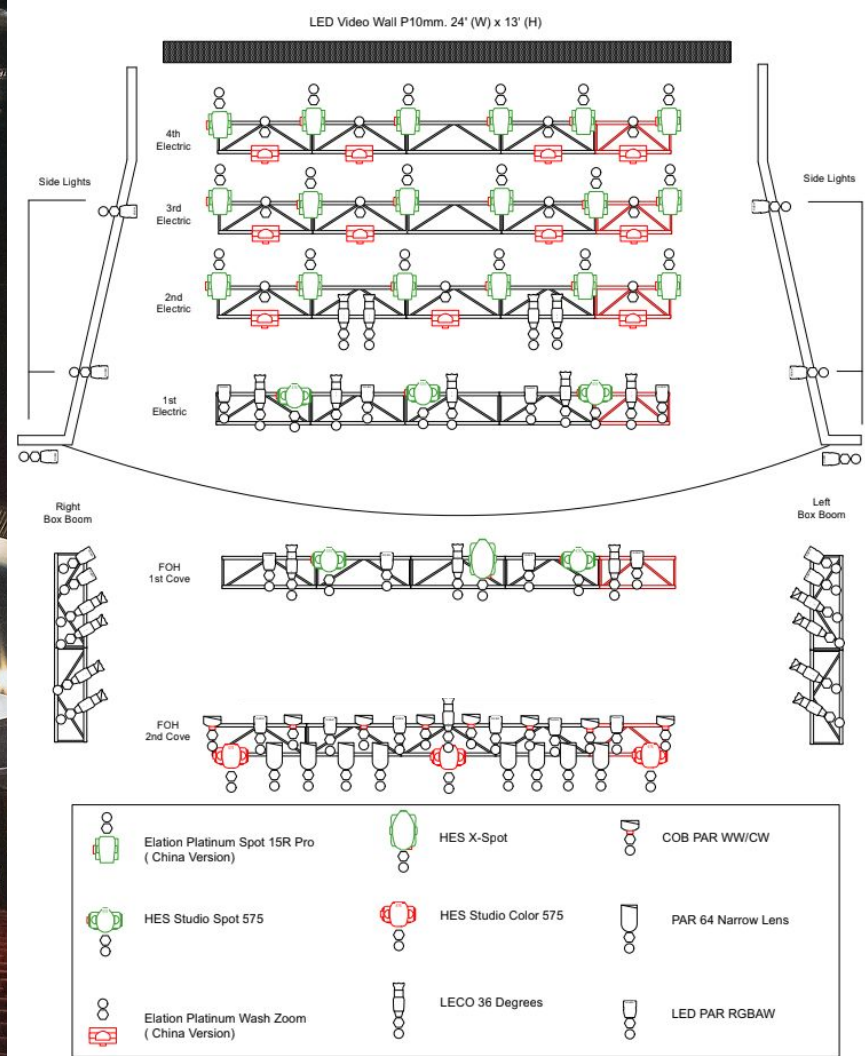



Bring beauty and excitement into your life and business with Oceania Theater, one of New York's best multi-profile venues.



ALL RENTAL ESTIMATES WILL BE TAILORED IN
ACCORDANCE WITH THE SPECIFICATIONS OF EACH
EVENT. LET US HELP YOU CREATE LASTING MEMORIES.
CONTACT US TODAY.

CONTACTS

Phone: (646) 200-1555

Email: exementertainment@gmail.com

Web: www.oceanatheater.com

Our Socials:

